

Peel Rivets

The peel rivet is an aluminium body, steel stem rivet suitable for joining soft materials such as wood, plastics and rubber. Rather than deforming the rivet body, the mandrel cuts the rivet body to form load spreading petals.

Material: Body: Aluminium 5056 (AlMg5)

Mandrel: Low carbon steel

Finish: Body: Bright plain

Mandrel: Zinc coated with clear passivation

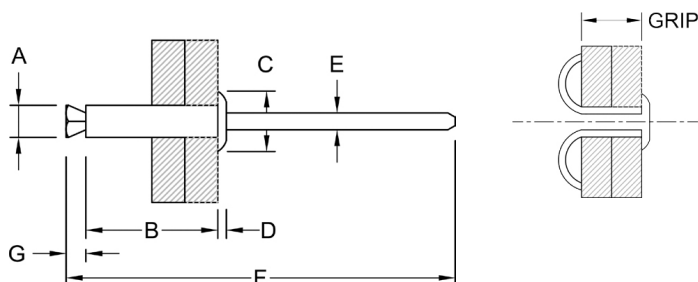

Diameter	Part Code	Grip	Hole	A	B	C	D	E	F	G
mm		mm	mm	mm	mm	mm	mm	mm	mm	mm

Aluminium Rivet / Steel Mandrel with Dome Head

3.2	73ASP-0406	3.0-9.0	3.3	3.15	13.0	6.4	0.9	1.8	48	1.8
	73ASP-0505	3.0-8.0	4.3	4.30	13.7	7.8	1.0	2.2	50	2.7
4.0	73ASP-0506	6.0-10.0	4.3	4.30	16.0	7.8	1.0	2.2	60	2.7
	73ASP-0604	2.0-6.0	5.0	4.95	12.0	9.3	1.3	2.6	50	3.0
4.8	73ASP-0606	5.0-9.5	5.1	4.95	16.0	9.3	1.3	2.6	55	3.0
	73ASP-0608	8.0-13.0	5.1	4.95	18.0	9.3	1.3	2.6	55	3.0
	73ASP-0610	11.0-16.0	5.1	4.95	20.0	9.3	1.3	2.6	59	3.0
	73ASP-0612	14.0-19.0	5.1	4.95	25.0	9.3	1.3	2.6	63	3.0

Aluminium Rivet / Steel Mandrel with Large Flange Head

4.8	73ASP-0606LF	5.0-9.5	5.1	4.95	16.0	14.0	1.3	2.6	55	3.0
	73ASP-0608LF	8.0-13.0	5.1	4.95	18.0	14.0	1.3	2.6	55	3.0
	73ASP-0610LF	11.0-16.0	5.1	4.95	20.0	14.0	1.3	2.6	59	3.0
	73ASP-0612LF	14.0-19.0	5.1	4.95	25.0	14.0	1.3	2.6	63	3.0

Dimensions and specifications are subject to change without notice. Check your distributor for the latest data sheet.

The test data provides approximate strength values averaged in multiple tests in various materials and thicknesses.

We recommend testing your application when an exact strength figure is required, or the load to be applied comes close to the published data.