

RIVSET

Self-pierce riveting for perfect joints

How it works

Positioning

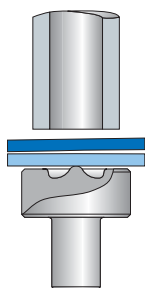

Holding

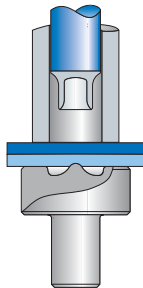

Piercing

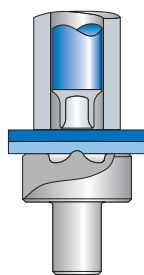

Stamping

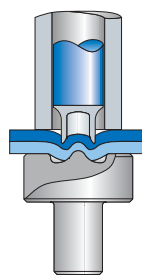

Forming

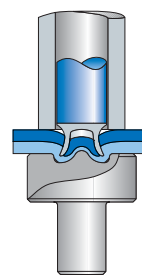

Setting

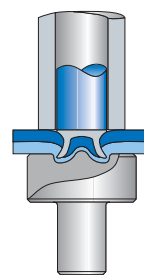

A simple and fast process:

In one step the semi-tubular rivet pierces through the upper layer/s of the workpiece and forms the locking head in the lower layer.

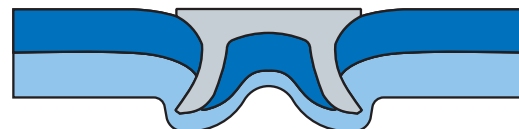

RIVTEC[®]
ASSEMBLY SYSTEMS AND SELF PIERCE RIVETS

BÖLLHOFF

Fixings

The fixings:

- High-strength
- Suitable for visual inspection
- Reproducible, no pre-drilling
- Watertight and airtight
- For joining metallic and non-metallic materials
- For fastening dissimilar metals
- For various thicknesses of material
- For various strengths of material

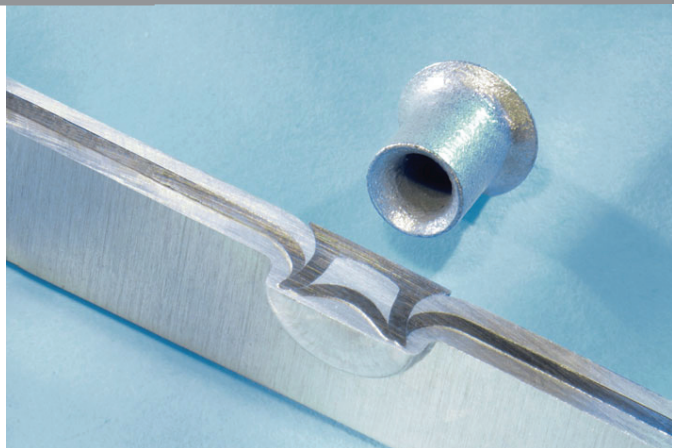

Materials

The fixings:

- Aluminium (pressure cast, extruded, sheet)
- Deep drawing steels with Rm up to 500 N/mm²
- High strength steels with Rm up to 1000 N/mm²
- Also material combinations with magnesium, copper, films, metal mesh, wood, plastic (with fibre glass if applicable), sandwich materials
- Adhesive as a middle layer



Steel 1.0 mm
Steel 1.0 mm



Aluminium 1.2 mm
Steel 1.0 mm
Aluminium 1.2 mm



Aluminium 3.0 mm
Aluminium 3.0 mm



Aluminium 1.2 mm
Magnesium 1.5 mm



Plastic 2.0 mm
Aluminium 2.0 mm



Plastic 3.0 mm
Aluminium 3.0 mm



Aluminium 1.2 mm
Adhesive
Aluminium 2.0 mm

General Industry

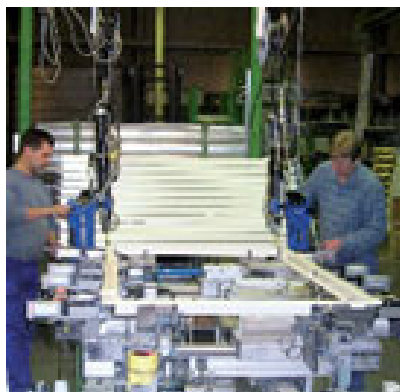

Manual use of self-pierce rivet systems with process monitoring; shown here for door and gate assembly. The large photo shows a manually-operated tool with gyrosopic handling device.



Production of air ducting segments with manually controlled components and integrated setting tool.



Fully automated production of motorway signs in optimised cycle time.



RIVSET® Classic – The reliable basis
Compact and versatile self-pierce rivet system

Self pierce rivet in use

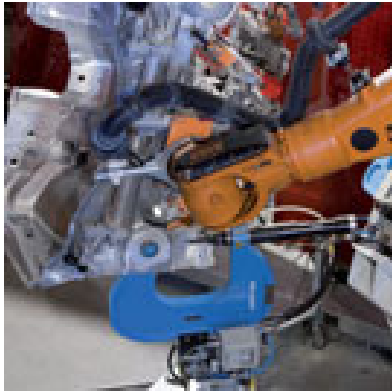

Automated setting of self-pierce rivets for all bodywork areas, assembly, interior and exterior. Shown here: body assembly with robot-operated component. The large photo shows a robot-operated tool.

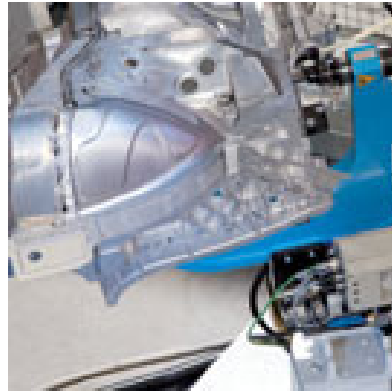

Similarly in body assembly, a stationary tool with robot-operated component.



Manual setting of self-pierce rivets here with hand-operated tool for simple sub-components.

